

Eastern Reliability's 16" See-Through Manway Cover is a convenient solution to easily inspect the interior of a tank and its contents at a glance.

### Product Description

#### ER-CLMW16 Standard Assembly:

- Standard 16" Lever Locking Manway Cover
- 15" Clear Acrylic disk
- EPDM Gasketing
- Silicone Bead

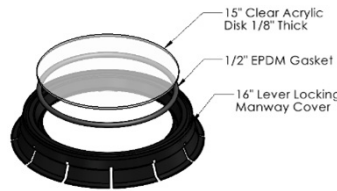

#### ER-CLMW16 Application:

- This lid is to replace an already existing 16" Lever Locking Manway lid
- This is compatible with all Assmann Polyethylene Tanks with 16" Lever Locking Lids

#### Ordering Information:

- This custom lid can be purchased through Eastern Reliability
- Part# ER-CLMW16



#### 16" See-Through Manway Cover

- Standard size 16" Lever Locking Manway cover converted with a port hole to visually inspect interior of tank and contents without having to remove lid
- Watertight with an EPDM gasket aligning the interior edge
- 13" port hole size

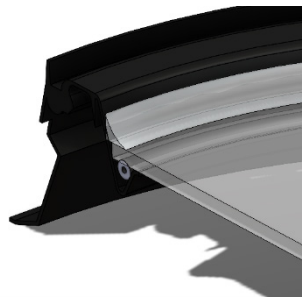

#### Maintenance

- *Silicone* - If manway cover is used in outdoor locations, the silicone bead can last anywhere between 10-20 years, depending on the location of the sealant in relation to the elements (sun and high winds). A new bead of silicone will need to be reapplied within that 10- to 20-year time frame to keep the integrity of the seal intact.
- *The acrylic porthole needs to be cleaned.* Use only a soft cotton (or microfiber) cloth. Sweep cloth over side to be cleaned to remove any loose dust, debris, or dirt. Use a cleaner: ONLY specified cleaning acrylic items to clean surface. Spray a different soft cotton (or microfiber) cloth to wipe on your acrylic. Be sure to wipe gently using your different (reduces possible scratches on surface) and wipe until cleaner is completely gone.